



# FIRE**FIGHTING** SOFTWARE

**THE LEADING SUITE OF SOFTWARE FOR  
THE FIRE FIGHTING DESIGN**



# CPI win® SPIDI

## SPRINKLER & HYDRANTS SYSTEM DESIGN SOFTWARE

When looking for a simple and complete software for sprinkler and hydrants system design **CPI win® SPIDI** is the right one for you, thanks to its easy and flexible user interface and the multitude of functions that allow fast and highly precise input: system design according to EN 12845 and NFPA 13 codes, sizing of the pipes and flow calculation, choice of the pumps, complete report, material list and finally technical drawing and sections in dwg.

Integration with BIM (via connector provided by ArchLine.XP) allows to import, in addition to a classic dwg, a file in IFC format from which to load the plans representing the building's floors with attached information.

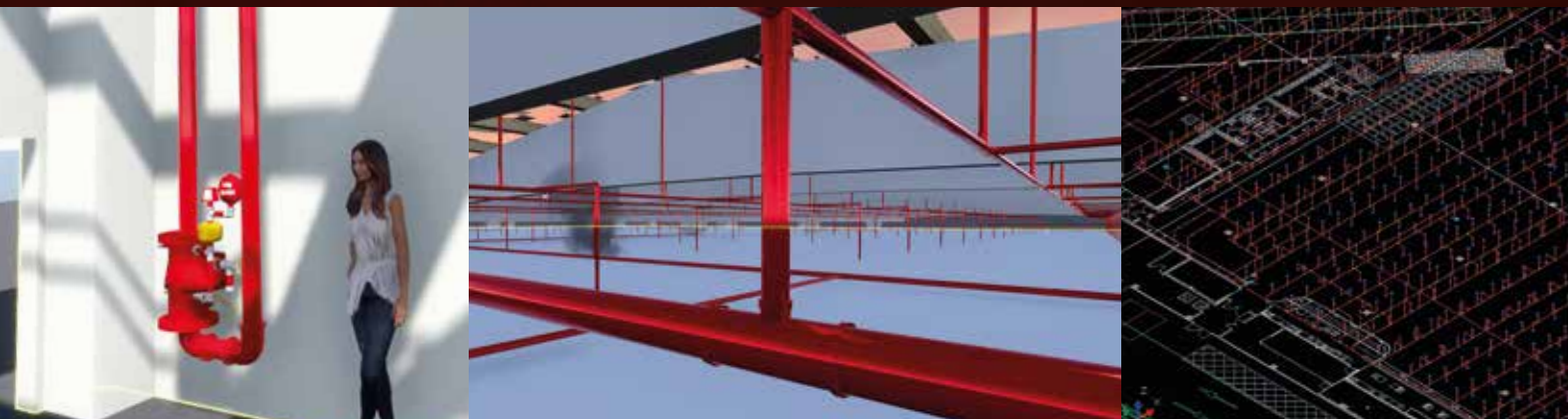

### SOFTWARE MAIN FEATURES

- Integrated easy 3D CAD with BIM features (IFC file creation) for systems of any shapes and size
- Commodity classification according to european and NFPA rules
- Wizards for the quick insertion of horizontal and vertical grids and pipes distribution in general
- 3D render of the drawn system interacting with single-line draw in real time
- Entity labelling for creating multiple filters
- Coverage area control and design check up
- Automatic insertion of supports and joints
- Real flow rate sizing and/or verification
- Real-time display of hydraulic performance of individual entities
- Choice of pumping unit (with NPSH)
- Calculation report, detailed parts list and technical design in DWG format



**FIND MORE INFORMATIONS ABOUT NAMIRIAL CPI WIN® SPIDI**





# CPI win® FSE

## FIRE SAFETY ENGINEERING & PEOPLE EVACUATION SIMULATION SOFTWARE

Fire Development and People Evacuation Simulation: from the design to the analysis of the results in a simple way (also with IFC BIM import). CPI win® FSE allows you to apply the principles of Fire Safety Engineering for firefighting and for the evacuation of people to safe places in an easy, accurate and at the same time revolutionary way.

The new technology of **CPI win® FSE** allows us to analyze the spread of fire and to study the development of combustion products in a simulated scenario using both the calculation engines FDS (fire simulation) and EVAC (people evacuation simulation) developed by NIST.



### SOFTWARE MAIN FEATURES

Integrated and easy 3D CAD

Design of walls, doors, windows and any parameters required by the models FDS 6.X (Fire Dynamics Simulator)

Automatic design of the scenario by importing an IFC file format

Definition of RHR curves according to device temperature activation, calorific value, etc...

Complete library of predefined objects to use for fire scenario simulation

Calculation of the time- temperature curve for each structure to use in **CPI win® REI**

SMOKEVIEW viewer to display the video simulation of calculation results

Innovative graphic simulation viewer

Display of the results obtained through graphs and diagrams

Calculation report



FIND MORE INFORMATIONS ABOUT NAMIRIAL CPI WIN® FSE



# CPI win® REI

## STRUCTURES FIRE RESISTANCE VERIFICATION SOFTWARE

The Namirial best solution for the analytical verification of fire resistance of structures in according to Eurocodes. The structures are verified using standard (nominal) fire curve or parametric (natural) fire curve, to simulate a fire case as close as possible to reality. **CPI win® REI** allows the verification of fire resistance for elements in reinforced and/or pre-stressed concrete (REI Ca-cap), steel structures (REI Steel), bearing and non-bearing walls (Rei Walls) and for wood structures (REI Wood).



### SOFTWARE MODULES

#### **CPI win® REI CA-CAP MODULE**

It verifies elements in reinforced and pre-stressed concrete, even in the presence of protective coatings. The program determines the thermal mapping according to the advanced method of Eurocode 2, then launches the ultimate limit state calculation.

#### **CPI win® REI STEEL MODULE**

It verifies steel section, even in the presence of protective coatings, in according to Eurocode 3. It's possible to calculate the value of critical temperature and verify the fire resistance of protected or not protected steel sections in according to the advanced method of Eurocode 3.

#### **CPI win® REI WALLS MODULE**

It verifies bearing or non-bearing walls in according to Eurocode 6. The program owns an internal CAD that draws the walls which have to be verified.

#### **CPI win® REI WOOD MODULE**

It verifies rectangular or circular wood structures in according to Eurocode 5.



**FIND MORE INFORMATIONS ABOUT NAMIRIAL CPI WIN® REI**



# SISMOSPRINK

## THE FIRST SOFTWARE FOR SIZING THE SEISMIC AND STATIC SUPPORTS OF THE SPRINKLER AND HYDRANTS FIRE PROTECTION SYSTEM

**Sismosprink** is aimed at all the designers of fire-fighting systems and fire-fighting professionals, who need to guarantee the tightness of the fire-fighting systems themselves, through a correct and indispensable design of the relative anti-seismic and static brackets.

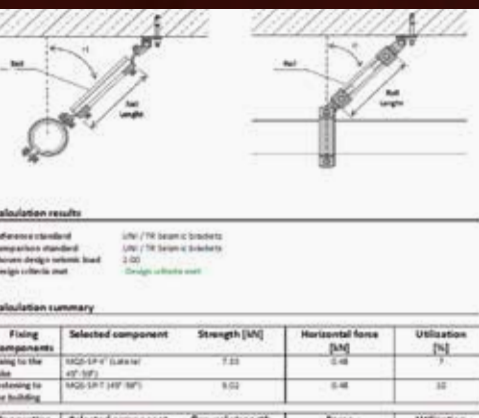

### FROM THE CLASSIFICATION TO THE DESIGN OF ANTI-SEISMIC AND STATIC SUPPORTS

Thanks to a guided and error-proof procedure, it allows you to perform both the classification for the framework of the chosen reference standard, and the automatic identification of seismic parameters thanks to a G.I.S. (Geographical Information System) fully integrated into the software.

### A WIDE RANGE OF HILTI PRODUCTS FOR A COMPLETE PROJECT

**Sismosprink** performs a calculation according to the chosen standard and automatically defines, thanks to the archives, the main adequate components, in terms of seismic force and traction, automatically creating a detailed report with quantities, pieces, and references to the products.

**Sismosprink** can generate various customizable technical reports that summarize the calculations and calculation results according to the technical standards used, both in word and pdf format.



FIND MORE INFORMATIONS ABOUT NAMIRIAL SISMOSPRINK





# FIREFIGHTING SOFTWARE

**CPI win®** is the family of leading software to solve in a professional, fast and intuitive way all the issues related to the fire prevention. Created in 1995, today is the most complete suite that allows you to operate according to the new regulation of Fire Safety Engineering (FSE).

The suite allows you to:

- **Design fire-fighting systems, even the most complex;**
- **Calculate and choice the seismic and static supports**
- **Simulate the fire development and the people evacuation**
- **Verify with tabular and/or analytic method, the fire resistance of structures.**

**CPI win®** allows also the analysis of the fire's phenomenon and the evacuation of people through real simulations based on the FDS and EVAC models.

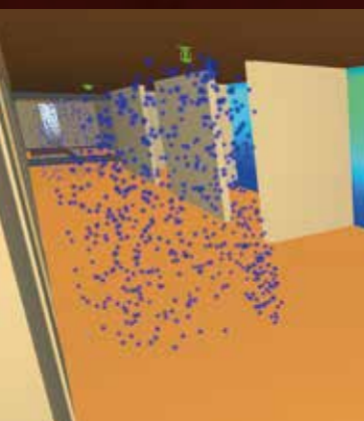

**CPI win® SPRINKLER  
& HYDRANTS**



**SISMOSPRINK**



**CPI win® FSE**



**CPI win® REI**